

accuraspray CS

Quick set-up guide

Online monitoring of cold spray processes for the shop floor



tecnar

Innovate to differentiate.

Before you begin

Unpacking the parts

The box should contain the following items:

1. Controller
2. HMI unit
3. Sensor head
4. Air filter and hoses
5. Substrate pyrometer and its support bracket (optional)
6. Communication cable, laser power cable and safety switch cable
7. Safety glasses

Carefully open the box, remove the content pictured and set it on a work surface.

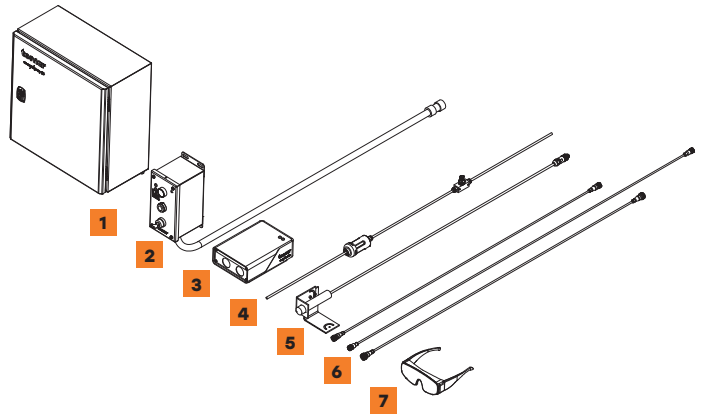

Register Now
Activate your warranty.
Get your free virtual training.



Registration Using QR Code or online:
spraysensors.tecnar.com/registration

Activate your warranty to start receiving benefits.

Our easy registration process ensures that you get the most from your sensor and enjoy peace of mind with your warranty.

- Get free virtual training
- Download manuals and procedures
- Get update alerts
- Chat with the technical team
- Take advantage of your warranty



Class 4 laser product warning:
Danger: invisible laser radiation.
Avoid eye or skin exposure to direct or scattered radiation. (Emitted wavelength: 900 - 1000nm, maximum output power: 40W)
Please refer to the user manual 40101-00075 laser safety section for more information.

1. Installing the sensor head

Where to install

Install the sensor head in the spray booth where the robot (spray gun) can easily reach it. It should be a permanent place so the robot can repeatedly reach the sensor head. Also ensure that the sensor head does not interfere with normal spraying operations.

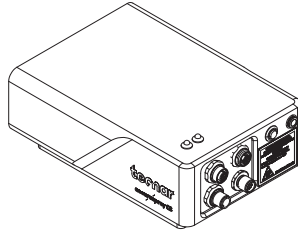

2. Installation procedure

Install the sensor head, using the 4 mounting holes, on a sturdy mounting plate that does not vibrate or move during spraying.

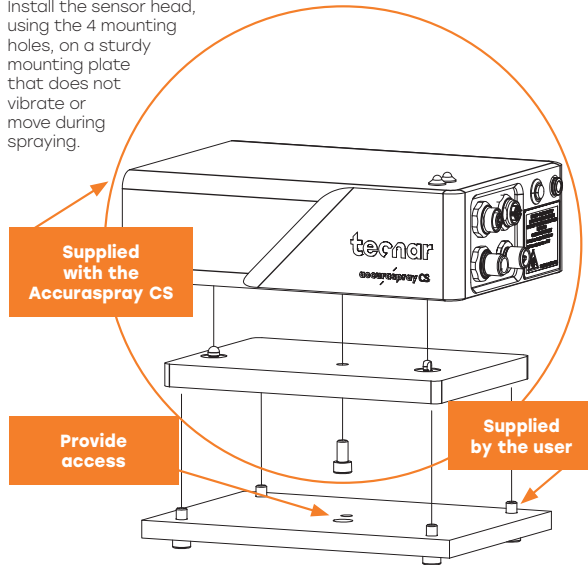

3. Adjusting the sensor head

Connect the compressed air supply and the communication cable to the sensor head. Pull the other end of the communication cable out of the spray booth. Connect the air hose to the booth air supply.

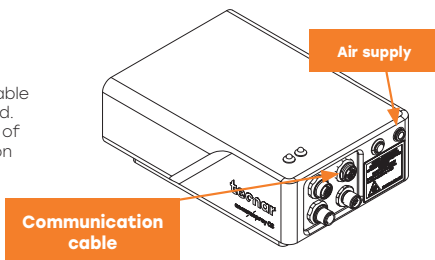

4. Installing the HMI

Install the HMI unit at the chosen location.

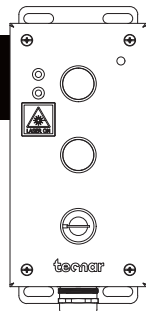

5. Installing the controller

Where to install

Install the controller outside the spray booth.

Installation procedure

Install the Wi-Fi antennas on the controller.

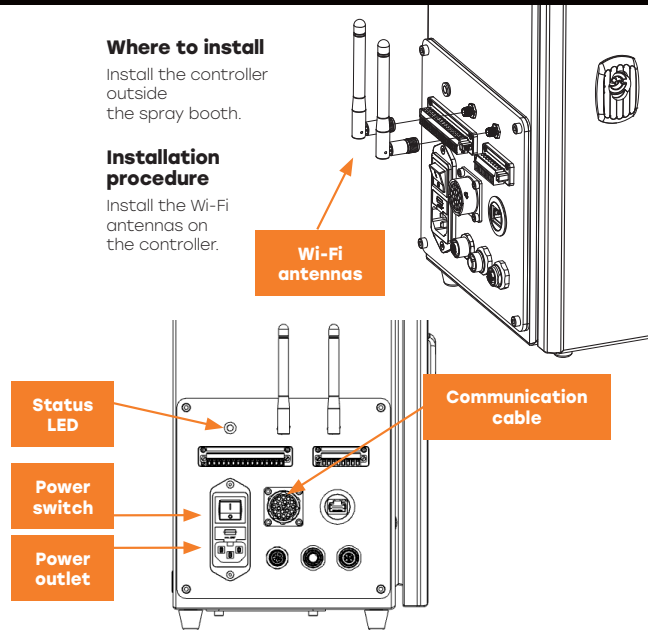

Connect the sensor head communication cable.

Connect the power cable to the controller and plug into a power socket. Flip the Accuraspray controller power switch to ON.

Wait until the status LED turns green.

6. Adjusting the spray gun position

Activate the alignment beam using the push button located at the back of the sensor.

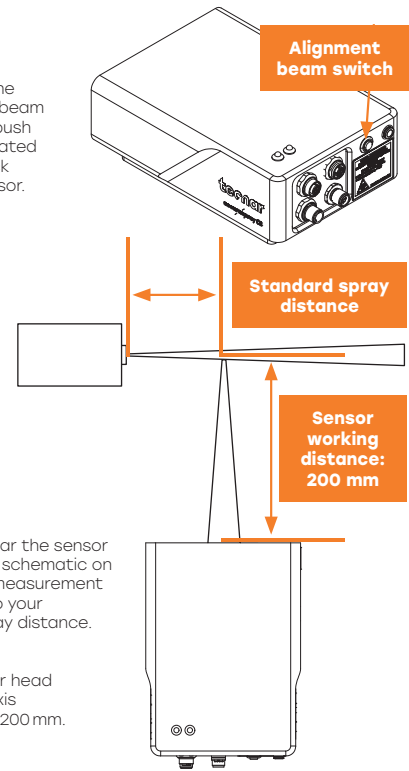

Bring the spray gun near the sensor head as shown on the schematic on the right. The sensor measurement point is normally set to your standard process spray distance.

The distance between the front of the sensor head and the spray torch axis should be adjusted to 200 mm.

7. Accessing the user interface

Accuraspray CS user interface is accessible through a web browser hosted locally on the controller, not available on the internet. We recommend using Google Chrome or Microsoft Edge for optimal performance. Go to the normal Wi-Fi menu on your computer or tablet and look for "Accura CS - serial number". The password to access the Wi-Fi is "accura.wifi".

Open your browser and enter the URL: <http://accuracs-00000000/> to connect to the Accuraspray user interface. Replace the zeros with the serial number of the unit you are trying to connect. The serial number consists of 8 digits which can be found in the Wi-Fi (SSID) network name or under the controller.